



# VOLUMETER

- ❑ VOLUMETRIC COUNTER, **rotating piston**, 8-digit-rolls direct reading on 360° rotating dial, preset for inductive sensor k=1
- ❑ Protection grade **IP 68** with mineral glass and copper can housing
- ❑ **Newly developed** mod. VSF DN 15, dry dial, for clean water, temperature class T50, ensuring:
  - Maximum quietness (< 20dB)
  - Reduced overall dimensions
  - Filter system for high resistance of suspended particles
- ❑ All models are MID approved according to the current Directive (module B+D), in compliance with **UNI EN ISO 4064** and **OIML R49**, achieving an R (Q3/Q1) up to 1000
- ❑ U0-D0: no straight pipe sections are required upstream and downstream of the meter
- ❑ All models are certified for use with drinking water according to **D.M. 174** of 6 April 2004

# VOLUMETER

## Technical Data – DN-inches

	15	20
<b>Continuous flow rate Q3 (m³/h)</b>	<b>2,5</b>	<b>4</b>
Max. flow rate for short period Q4 (m³/h)	3,125	5
Transitional flow rate Q2 (l/h)	8	12,8
Minimum Flow rate Q1 (l/h)	5	8
Mesuring range R (other R's available on request)	500HV	500HV
Starting flow (l/h)	0,5	0,5
Pressure loss class ΔP (bar)	0,63	0,63
<b>Body material</b>	<b>Composite/Brass</b>	<b>Brass</b>
Working environmental temperature	-25° +55°C	
Max. allowed working pressure MAP (bar)	16	16
Dial register from/to (m³)	0,0001 / 100.000	0,0001 / 100.000
L) Length without couplings (mm)	110	190
<b>(other lengths available on request)</b>		
Length with couplings (mm)	190	290
H) Maximum height standard model (mm)	105	130
H1) Maximum height with pulse output (mm)	150	170
B) Maximum overall diameter (mm)	98,5	90
Weight with couplings (kg)	0,69	1.8
Weight without couplings (kg)	0,49	1.5

The following options are available on request:

- ☐ Models complete with data transmission via radio frequency 868Mhz with LoRaWAN, W-Mbus OMS or both with **automatic switch**
- ☐ On request LoRaWAN protocol with 915mhz frequency
- ☐ Non-return valve built-in in outlet pipe
- ☐ 5-digit-rolls counter
- ☐ Polycarbonate glass

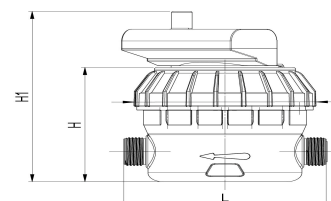

Head loss diagram

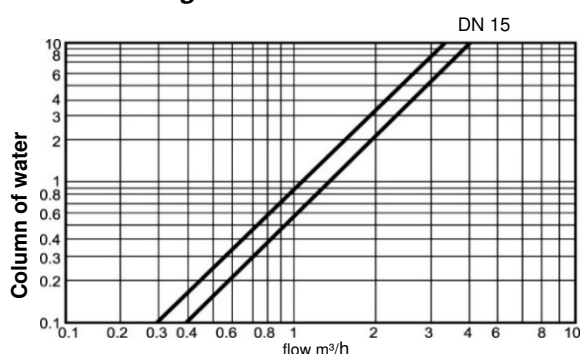

Typical error curve

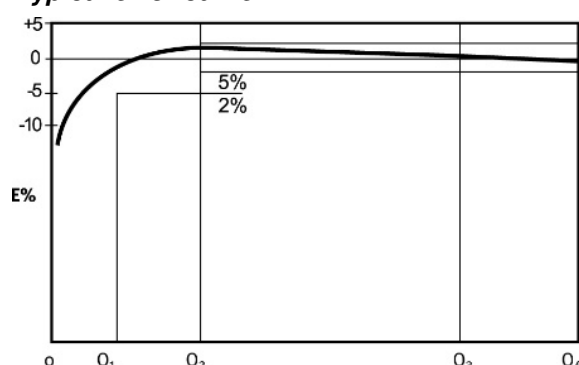

The Company reserves the right to make changes to technical data and product illustrations - 02/22



**G2 misuratori S.r.l. -**  
**Via San Martino, 38 – 14100 ASTI (AT) – ITALY**  
**Tel. +39.0141.721787– Fax +39.0141.702280**  
**E-mail: [info@g2misuratori.it](mailto:info@g2misuratori.it)**  
**[Http://www.g2misuratori.it](http://www.g2misuratori.it)**  
**Filiale Centro-Sud**  
**Via Fontanelle, 3 – 00020 RIOFREDDO**  
**Citta metropolitana di Roma Capitale – ITALY**  
**Tel. e Fax +39.0774.920216**

AZIENDA CON  
 SISTEMA DI GESTIONE  
 CERTIFICATO DA DNV  
 ISO 9001 • ISO 14001  
 ISO 45001

# VOLUMETER

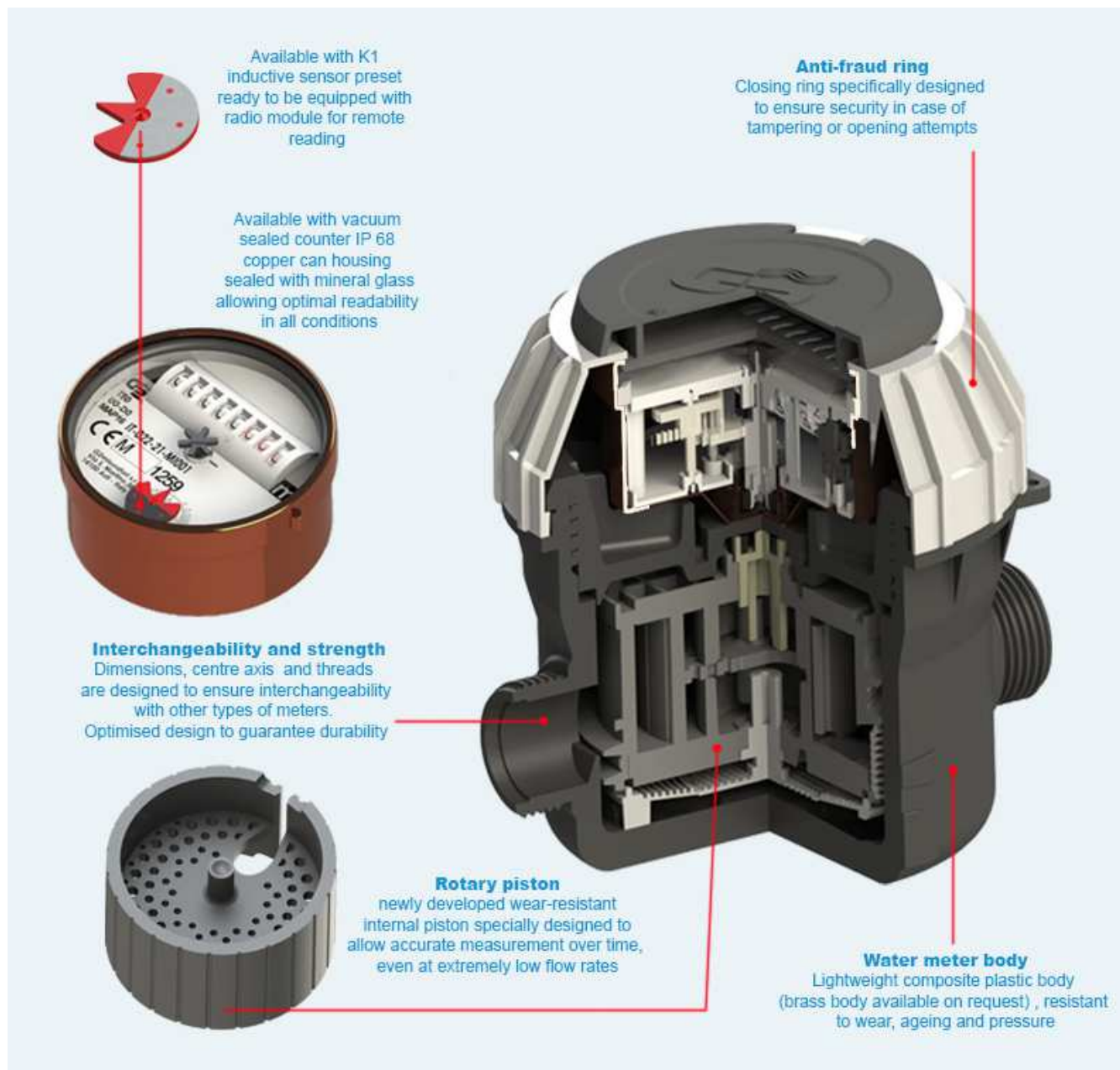

G2 misuratori S.r.l. -  
Via San Martino, 38 - 14100 ASTI (AT) - ITALY  
Tel. +39. 0141.721787- Fax +39.0141.702280  
E-mail: [info@g2misuratori.it](mailto:info@g2misuratori.it)  
[Http://www.g2misuratori.it](http://www.g2misuratori.it)

Filiale Centro-Sud  
Via Fontanelle, 3 - 00020 RIOFREDDO  
Città metropolitana di Roma Capitale - ITALY  
Tel. e Fax +39.0774.920216  
E-mail: [centrosud@g2misuratori.it](mailto:centrosud@g2misuratori.it)

AZIENDA CON  
SISTEMA DI GESTIONE  
CERTIFICATO DA DNV  
ISO 9001 • ISO 14001  
ISO 45001