

INDUCTIVE SENSOR WITH EMBEDDED LORAWAN RADIO MODULE for fixed network and LORA for walk-by/drive-by MODEL G2-IPS-CLW for AFMS/BFM/QDFM/ BFU/PFU/QDFU/WEF-HV preset water meters

Inductive Sensor radio module available in **compact** version for multiple and single jet water meters with wet dial, liquid filled counter type, fully protected dial, and super dry dial, MID approved, preset for inductive sensor in **K1** and for WEF HV Woltmann meters, Mid approved, preset **K10** from DN 50 to DN 125 and **K100** from DN 150 onwards. The measurement of the water is done by conveying the flow rate into a rotation of a **star index fitted with an not magnetic metallic disk** placed on the water meter dial.



-Transmission

Bidirectional on 868 MHz frequency on both LoRaWAN™ protocol for fixed network and LoRa for walk-by/drive-by

- Installations

Indoor and outdoor

- Consumption data

Net compensated of any possible reverse flow

- Data security

Multi-level cryptography

- Transmission activation

Through actuator on instrument main part

- Configuration data update

Remote configuration on fixed network and/or via radio terminal

- Transmitted data

Sensor ID, consumption data, hardware status, alarms, battery level, temperature on site on request

- Transmitted alarms

mechanical fraud (cable cut and sensor removal), reverse flow, low battery, leakage

TECHNICAL FEATURES model G2-IPS-CLW

Kind of device	Microprocessor device	Network type	Fixed network LoRaWAN	Walk-by/Drive-by LoRa with owner protocol
Power supply	Lithium battery 3,6 V	Flexibility	Automatic switchover between 2 settings based upon set-up	
Battery life	10 years	Activation type	OTAA-ABP	
Max. pulse freq.	10 Hz	Transmission Interval	1 single daily reading and 2 daily transmission of historical data	Configurable for days and weekly hours
Environment operating conditions	-10 °C ... +55 °C	Transmission distance	Up to 14km in environment best operating conditions	Up to 1km in open field or 100 mt for installation on cast iron closed manhole
Storage temperature	-20 °C ... +60 °C			
Protection rate	IP68			
Certifications	Compliant to directive 2014/53/UE, the full text of UE declaration is available on website: http://www.g2misuratori.it/sites/cert.htm			

In accordance to the Recommendation ERC/REC 70-03 dated October 2018, Annex 2, banda C1, no restrictions to the use within EU+EFTA countries apply

Radio module assembly before sealing

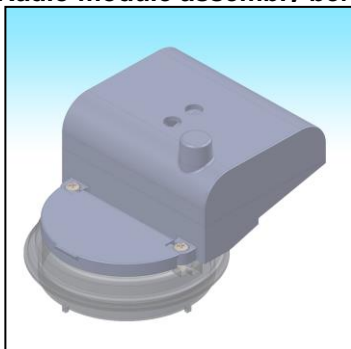

LIST OF COMPONENTS

1. G2-IPS Sensor
2. Dial lid
3. Fixing screws (n. 2)
4. Seal labels (n. 2)

exploded view drawing with assembly sequence

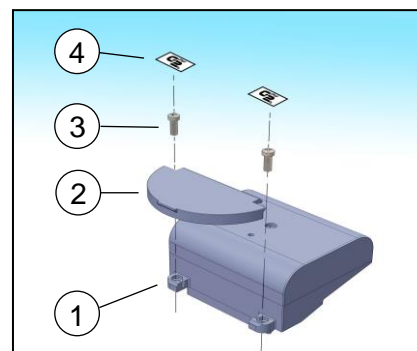

We reserve the right to make changes to technical data and product illustrations – 04/20