

## Portable testing bench to check water meters installed in plumbing networks

### ❑ For cold water, temperature class T30

Approvals:

- water meter: CE MID MI001
- electronic counter: UL508, CSA C22.2 No. 14, Lloyd

### ❑ Water meter master Mod. PFML/20 for cold water, temperature class T30, $Q_3$ 4,0 m<sup>3</sup>/h, measuring range R160, fully equipped with reed pulse emitter, with pulse value of 1 pulse / 1 litre

### ❑ Electronic counter with an 8 digit display, with external and manual resetting for litres reading, self powered by a 7 years long life lithium pad battery

### ❑ Upper housing made of shockproof lexan, sides and bottom made of metal with handle to carry

### ❑ Threaded male fittings 3/4" GAS

### ❑ Clear plastic cover allows direct master meter reading of m<sup>3</sup> and its submultiples



#### Technical data

Permanent Flow Rate $Q_3$ (m <sup>3</sup> /h)	4,0
Max. flow rate for short period $Q_4$ (m <sup>3</sup> /h)	5,0
Transitional flow rate $Q_2$ R160 [MPE $\pm 2\%$ ] (l/h)	40
Min. flow rate $Q_1$ R160 [MPE $\pm 5\%$ ] (l/h)	25
Starting flow R160 (l/h)	5
Accuracy class	2
Environmental class	C
Pressure loss class $\Delta P$ (bar)	0,63
Max allowed working pressure MAP (bar)	16
Master meter dial register from (m <sup>3</sup> )	0,0001
Master meter dial register to (m <sup>3</sup> )	99 999
Electronic counter dial register from (l)	1
Electronic counter dial register to (l)	99 999 999
Weight without packing (kg)	5,500

N.B. – THE CARRYING HANDLE CAN BE RECLINED

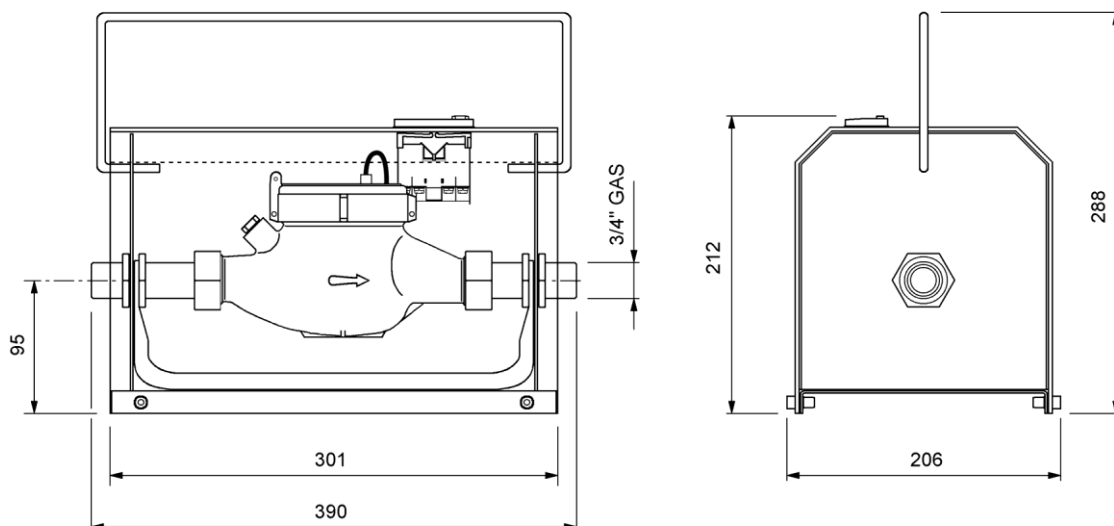

The company's policy is one of continuous product improvement and the right is reserved to modify the specifications herein contained without notice – 04/18

G2 misuratori S.r.l.

Via San Martino, 38 – 14100 ASTI (AT) – ITALY

Telefono +39.0141.727749 – Telefax +39.0141.702280

E-mail: [info@g2misuratori.it](mailto:info@g2misuratori.it) – [Http://www.g2misuratori.it](http://www.g2misuratori.it)

AZIENDA CON  
SISTEMA DI GESTIONE  
CERTIFICATO DA DNV  
ISO 9001 • ISO 14001  
ISO 45001

Filiale Centro-Sud  
Via Fontanelle, 3 – 00020 RIOFREDDO (RM) – ITALY

Telefono e Fax +39.0774.920216

E-mail: [centrosud@g2misuratori.it](mailto:centrosud@g2misuratori.it)